

2-4 Forest Drive East, Leytonstone, Greater London, E11 1FA
£1,700 Per Month



2-4 Forest Drive East, Leytonstone, Greater London, E11 1FA

£1,700 Per Month

Council Tax Band: B

Nestled in the vibrant area of Leytonstone, this modern one-bedroom upper floor flat on Forest Drive East offers a delightful living experience. Available to let at a competitive price of £1,700 per calendar month, this property is perfect for individuals or couples seeking a comfortable and stylish home.

Upon entering, you will find a well-proportioned reception room that provides a welcoming space for relaxation and entertainment. The flat features a spacious bedroom, designed to be a tranquil retreat, ensuring a restful night's sleep. The modern bathroom is equipped with contemporary fixtures, adding to the overall appeal of the property.

The flat's location is particularly advantageous, with excellent transport links nearby, making it easy to commute to central London and beyond. Leytonstone is known for its diverse community and offers a variety of local amenities, including shops, cafes, and parks, all within easy reach.

This property is ideal for those who appreciate modern living in a lively neighbourhood. With its appealing features and convenient location, this flat is not to be missed. Arrange a viewing today to experience all that this lovely home has to offer.









337 Forest Road
London
E17 5JR
02085277007

enquiries@completion.co.uk
completion.co.uk

Ground Floor
Approx. 58.0 sq. metres (624.5 sq. feet)

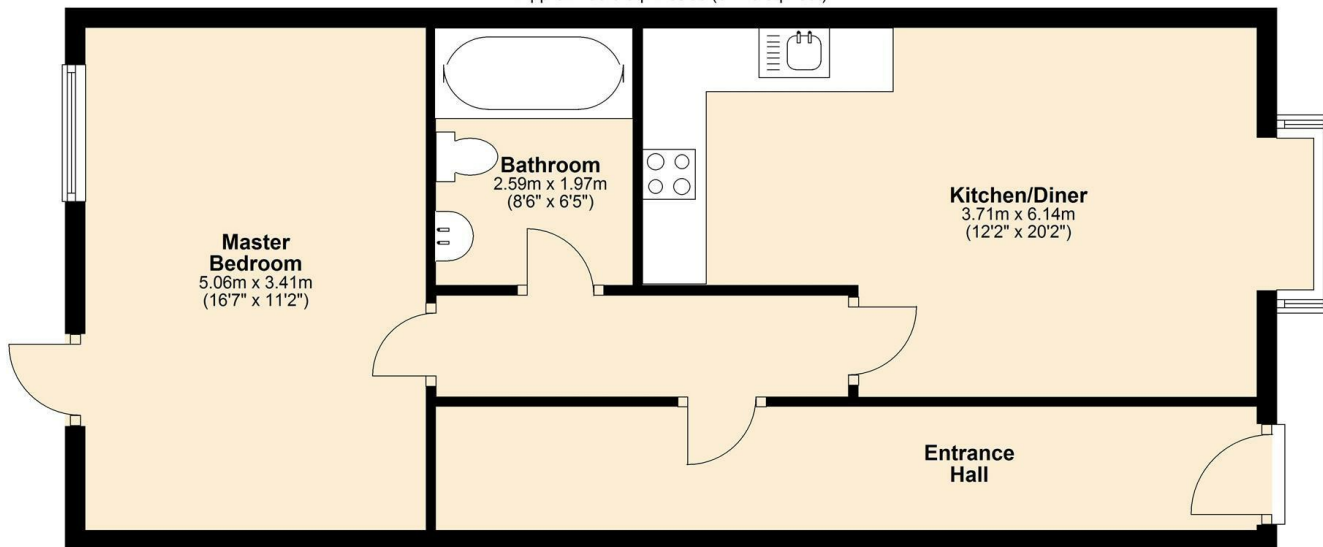

Energy Efficiency Rating		
	Current	Potential
Very energy efficient - lower running costs		
(92 plus) A		
(81-91) B		
(69-80) C		
(55-68) D		
(39-54) E		
(21-38) F		
(1-20) G		
Not energy efficient - higher running costs		
England & Wales	EU Directive 2002/91/EC	